

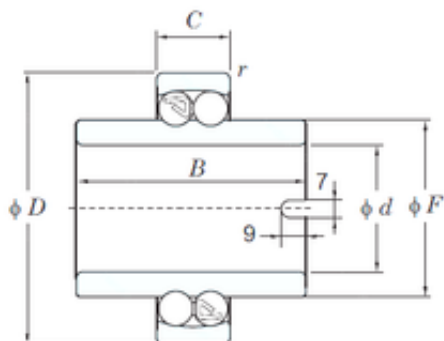

IOR Bearing Manufacturing Co.,Ltd

KOYO 11210 self aligning ball bearings



Bearing No. 11210

Size	50x90x58 mm
Bore Diameter	50 mm
Outer Diameter	90 mm
Width	58 mm
d	50 mm
D	90 mm
B	58 mm
C	20 mm
r min.	1.1 mm
F	62.7 mm
Da max.	83.5 mm
ra max.	1 mm
Weight	0.875 Kg
Basic dynamic load rating (C)	22.7 kN
Basic static load rating (C0)	8.10 kN
(Grease) Lubrication Speed	6500 r/min
(Oil) Lubrication Speed	7900 r/min
Calculation factor (e)	0.21
Calculation factor (Y0)	3.22
Calculation factor (Y1)	3.07

11210 Bearing 2D drawings and 3D CAD models